







FASTPLANK™

Basic Installation Guide

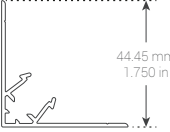
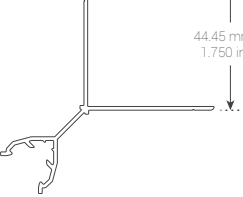
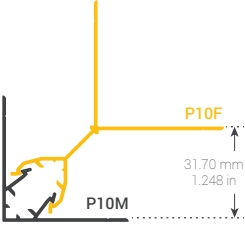

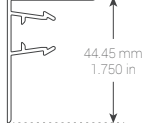
A Complete 4" and 6" V-NOTCH™
Aluminum Plank Siding System

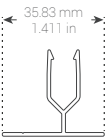

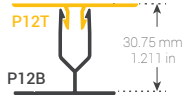

TWO-PIECE TRIMS

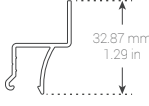
P10M Inside / Outside Corner Male	P10F Inside / Outside Corner Female	P10 Inside / Outside Corner
 <p>44.45 mm 1.750 in</p>	 <p>44.45 mm 1.750 in</p>	 <p>P10F 31.70 mm 1.248 in P10M</p>
P11B J-Trim Backplate	P11T J-Trim Top Cap	P11 J-Trim
 <p>41.091 mm 1.62 in</p>	 <p>44.45 mm 1.750 in</p>	 <p>P11T P11B 32.13 mm 1.264 in</p>
P12B Vertical Trim Backplate	P12T Vertical Trim Top Cap	P12 Vertical Trim
 <p>35.83 mm 1.411 in</p>	 <p>44.45 mm 1.750 in</p>	 <p>P12T P12B 30.75 mm 1.211 in</p>

CLIPS & CONNECTORS

P22 FASTPLANK™ Clip	P23 FASTPLANK™ Connector
 <p>32.87 mm 1.29 in</p>	 <p>11.86 mm 0.46 in</p>

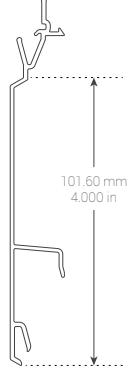
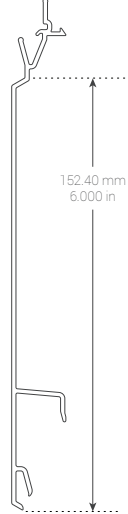
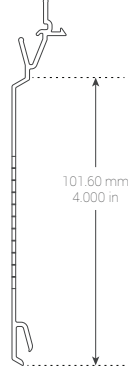
PLANKS

P24V V-NOTCH™ 4" Plank	P26V V-NOTCH™ 6" Plank	P27V Perforated V-NOTCH™ Soffit Plank
 <p>101.60 mm 4.000 in</p>	 <p>152.40 mm 6.000 in</p>	 <p>101.60 mm 4.000 in</p>
P21 Perforated Starter Track		
 <p>27.5 mm 1.08 in</p>		

*For marketing purposes only. The contractor / builder must verify all project and product dimensions on the job and report any discrepancy before proceeding with the work. All drawings and specifications are instruments of service and the copyright property of FASTPLANK™ Systems™ and must be returned upon request.

Before Getting Started

Read this **Basic Installation Guide** thoroughly and in its entirety.

Identify and understand all necessary building codes that apply to your jurisdiction.

Wear appropriate personal protective equipment (PPE) and ensure all necessary safety equipment is present and confirm a safe work site.

Inspect all FASTPLANK™ material for damage, defect, color, and specification.

Ensure that all the required tools are available and in good working condition. Failure to complete all these initial steps to get started, ensure applicable building codes are met, and review all product documents prior to starting product installation, may impact product performance, void the product and/or finish warranty, cause loss of your time and money, and increase the risk of personal injury.



Required Tools & Accessories

- 1 Sawhorses / worktables
- 2 Mitre saw
- 3 Circular saw, handheld with guide
- 4 Non-ferrous saw blades intended for cutting aluminum
- 5 Power cord
- 6 Impact driver / drill, with appropriate bits
- 7 Drill bit set
- 8 Carpenter's pencil
- 9 Chalk line
- 10 Level
- 11 Carpenter's Square
- 12 EasyTrim Reveals® HammerBlock®
- 13 Hammer
- 14 Rubber dead blow hammer
- 15 Tape measure
- 16 Silicone applicator
- 17 Silicone adhesive

Nice To Have

- 18 Laser level
- 19 Pnuematic nail gun
- 20 Air compressor & air compressor hose
- 21 Utility knife
- 22 Needle nose pliers
- 23 Pry bar
- 24 Tin snips



Fasten Horizontal Starter Track (P21)

- 1 Complete the building wrap / envelope according to the project specification before the FASTPLANK™ system is installed on the wall. The Perforated Starter Track (P21) is the first trim to be fixed to a flat wall.
- 2 Ensure that the Perforated Starter Track is level and plumb before fastening. Nail the Starter Track across the length of the wall and continue to verify the level.
- 3 Screw the Perforated Starter Track, at 16" on center intervals, across the horizontal length.

Metal Screw
3/4" Self-Tapping Screw

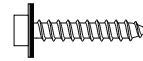

Nails
1 1/4" or greater, hot-dipped galvanized ring-shank

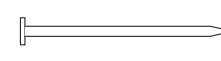

P21
Perforated Starter Track

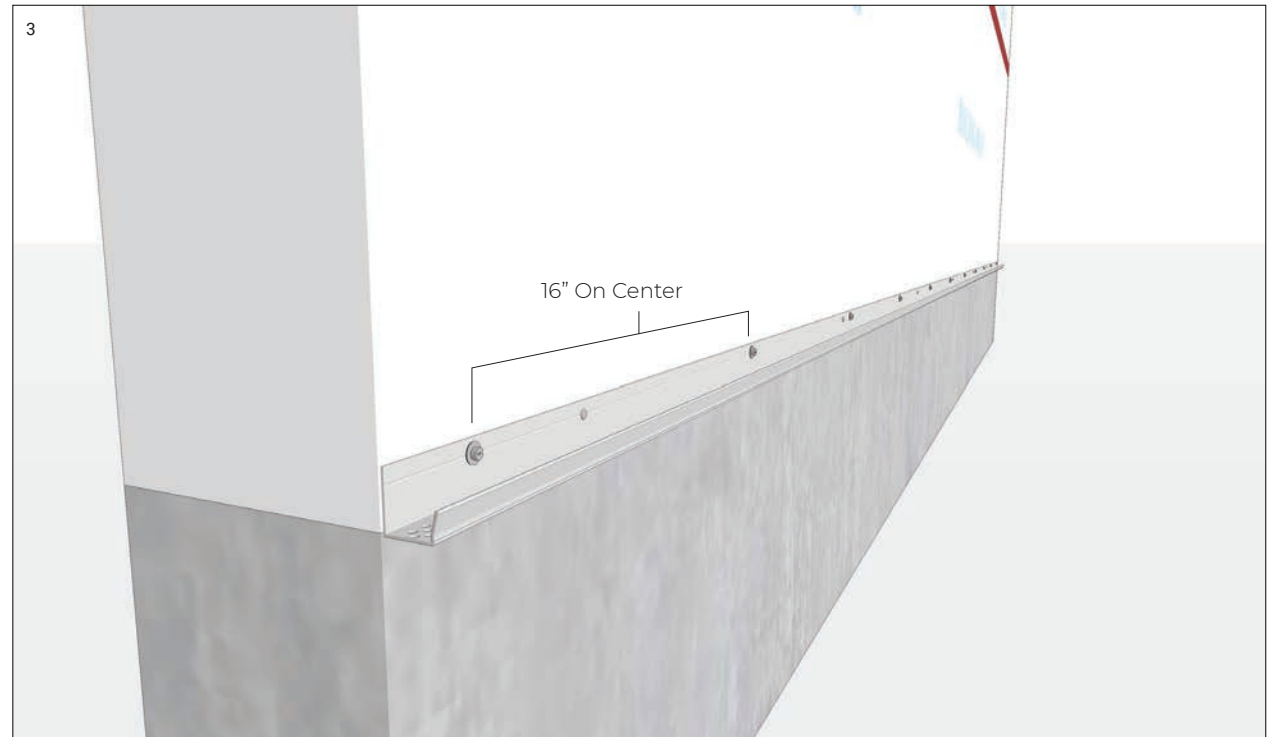
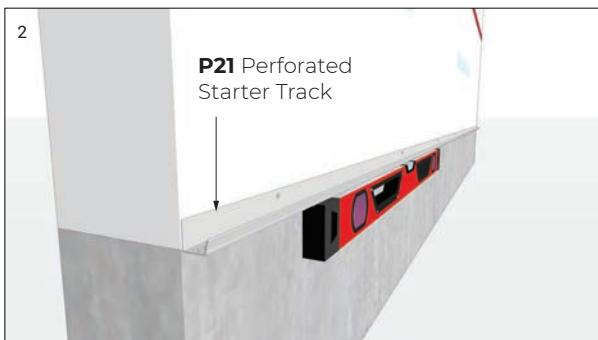
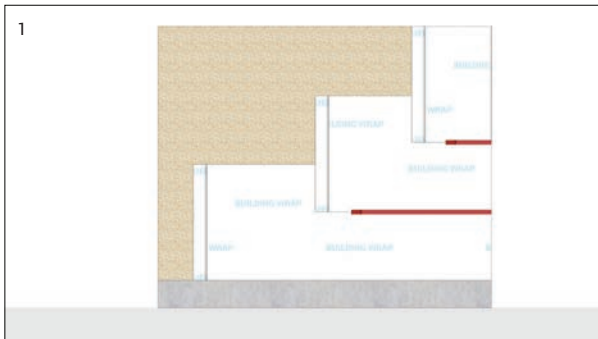
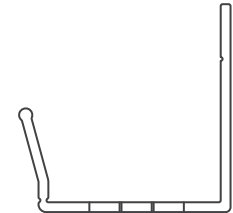

Install J-Trim Backplate (P11B)

- 1 Align J-Trim (P11B) with the vertical perimeter of the wall, and perpendicular to the Perforated Starter Track (P21).
- 2 Ensure the J-Trim (P11B) is level and plumb before fastening. Fasten with metal screws every 16" on center. Install the other vertical perimeter of the wall, as above.

P11B
J-Trim Backplate

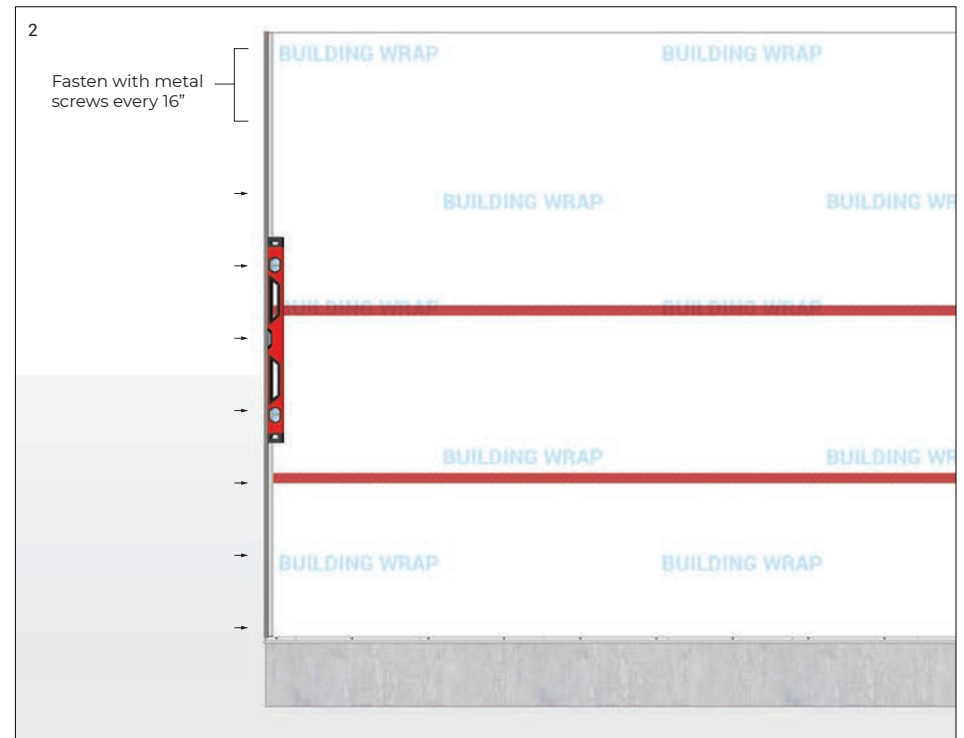
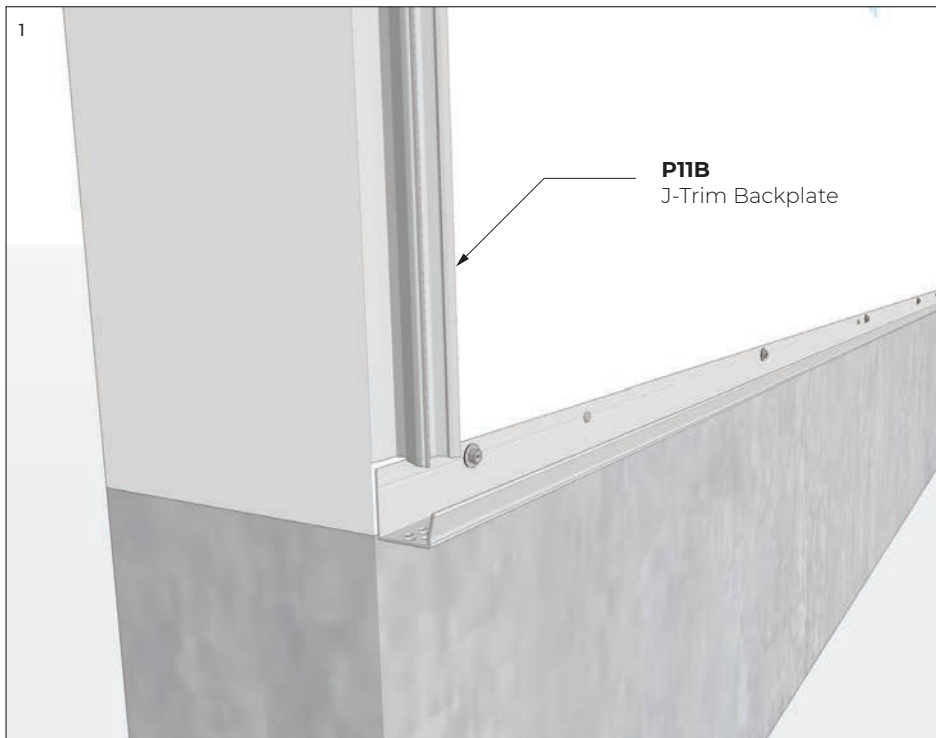
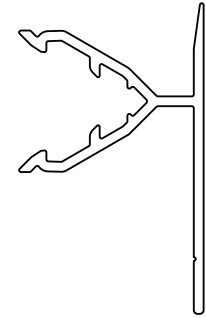

Install First Plank (P24V or P26V)

- To install the first plank, start at the bottom of the wall and align the Backplate of the Plank at an angle then push back to secure the Plank on the Starter Track.
- Using the FASTPLANK™ Clip (P22) and metal screws, secure the plank to the wall.
- Secure FASTPLANK™ Clips (P22) 16" on centre across the length of the Plank.
Continue this process for each horizontal plank up the vertical span of the wall as necessary.

P22
FASTPLANK™ Clip

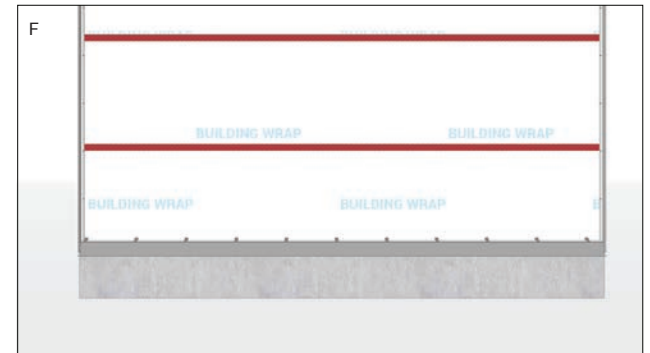
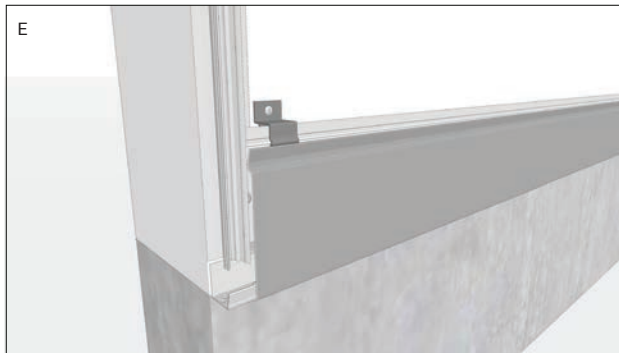
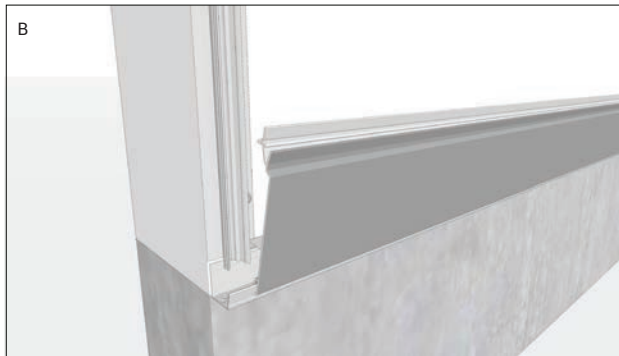
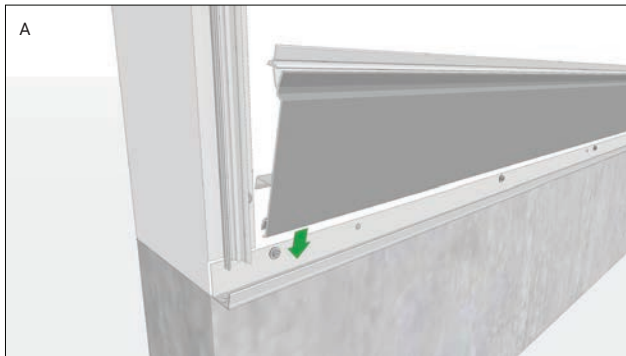
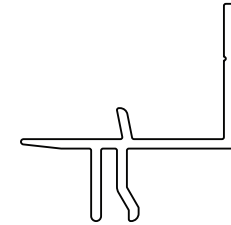

Using FASTPLANK™ Connectors (P23)

- A FASTPLANK™ Connector is used when the horizontal width of the wall requires two (or more) planks to complete. This will fasten the planks together to create a longer horizontal span of cladding.
- Align and secure the FASTPLANK™ Connector (P23) at the top of the connection point of each plank.
- Clip the FASTPLANK™ Connector in place and secure the FASTPLANK™ Connector to the wall with a metal screw on each corresponding plank.

P23
FASTPLANK™ Connector

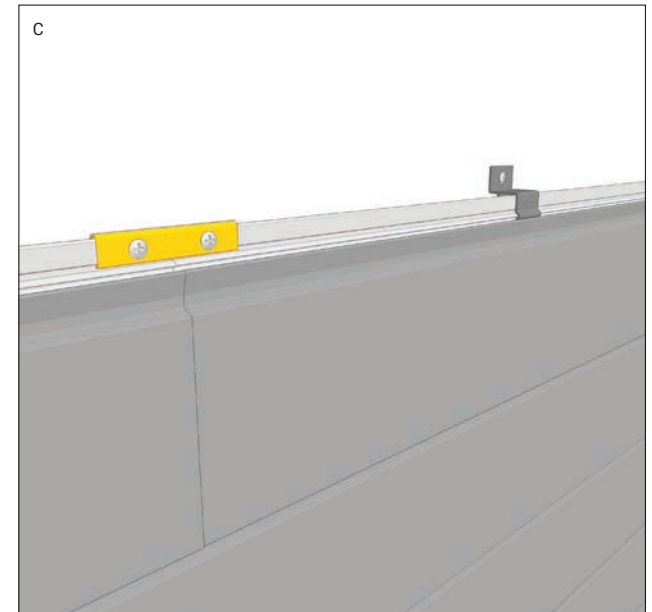
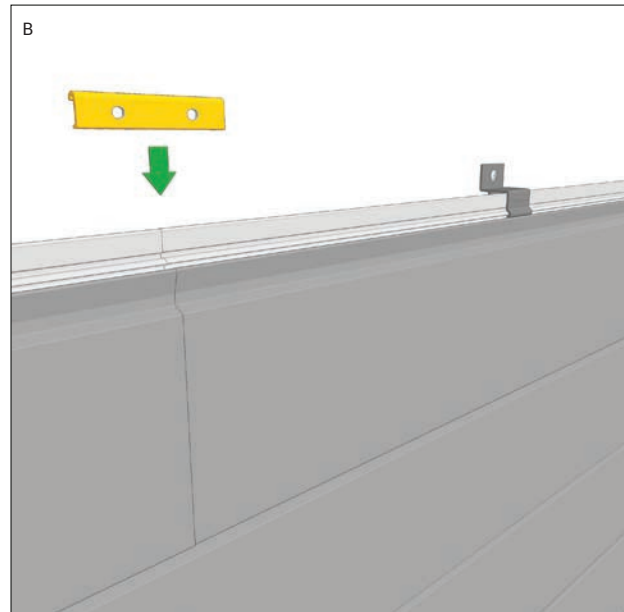
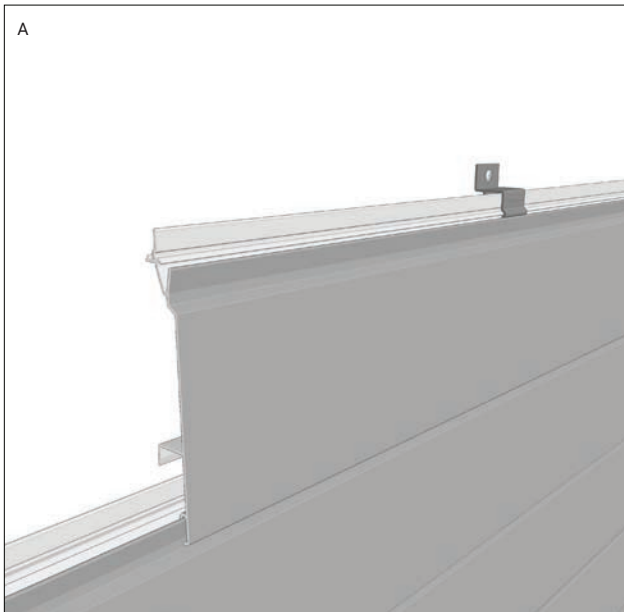

Complete Plank Install

- Measure and install a J-Trim Backplate (P11B) horizontally at the top of the wall to align EZ.Line® to EZ.Line® with the vertical J-Trim on the wall perimeter.
- Fasten with metal screws every 16" to 24" on center.
- If necessary, cut the top Plank (P24V or P26V) so that it aligns with the EZ.Line® (the screw-set line) of the top horizontal J-Trim Backplate (P11B).

P11B
J-Trim Backplate

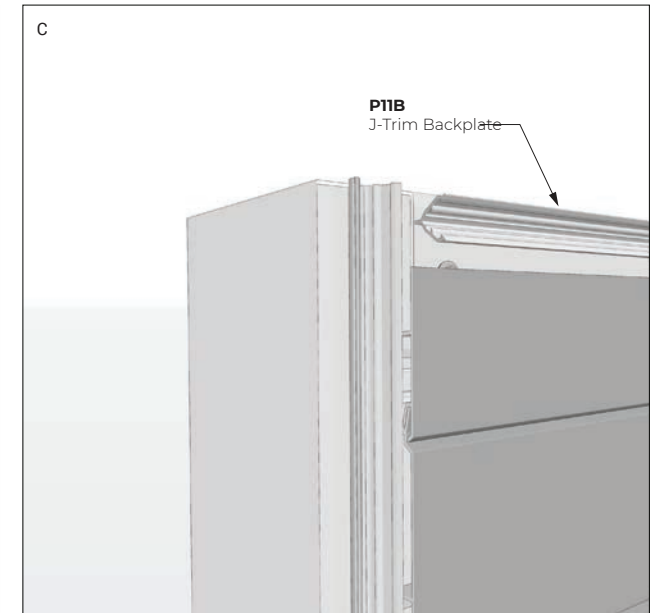
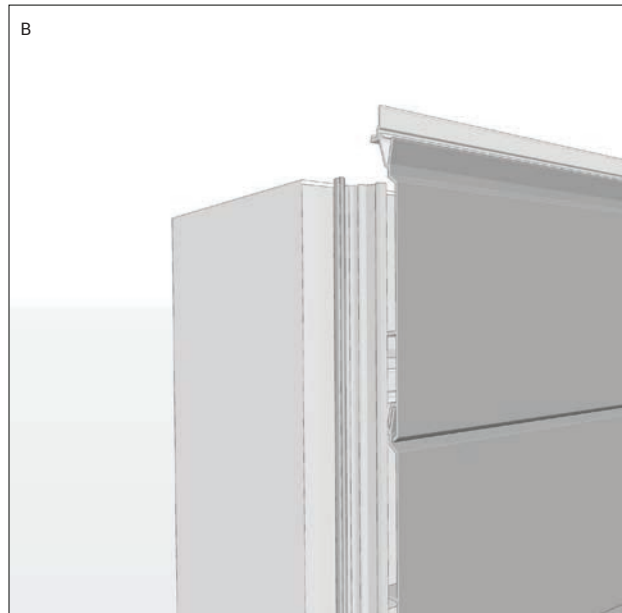
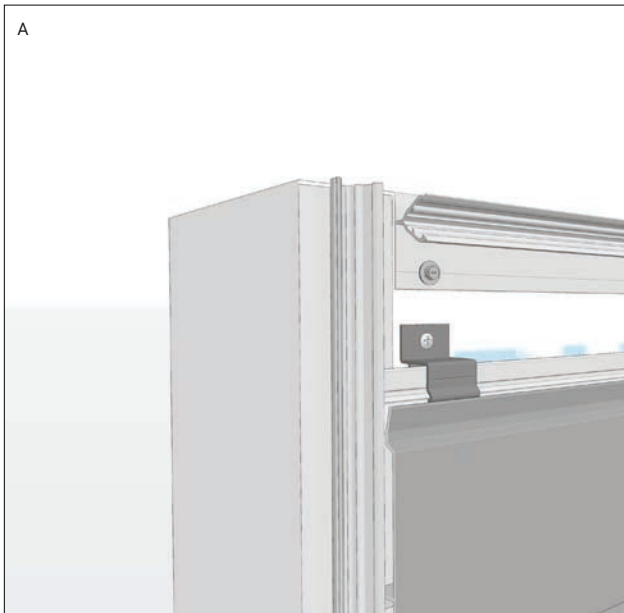
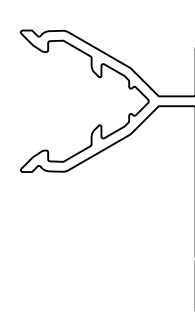

Install Top Caps (Page 1 of 2)

- Start the installation of the Top Caps on the vertical perimeter of the wall.
- Add a 2" to 3" bead of Silicone to the caulking channels, every 2' to 3'.
- Notch the vertical P11 J-Trim Top Cap to accommodate the P21 Starter Track at the Backplate of the wall.
- Secure the Top Cap to the Backplate.

P11B
J-Trim Backplate

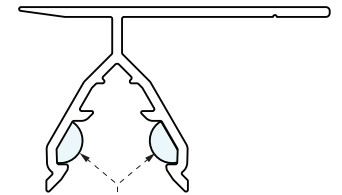

Silicone
Add 2" - 3" beads to the caulking channels.

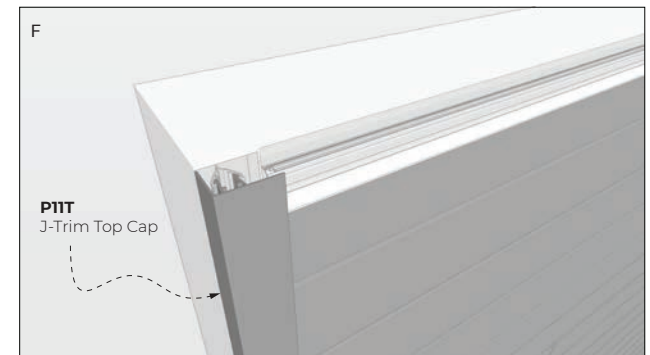
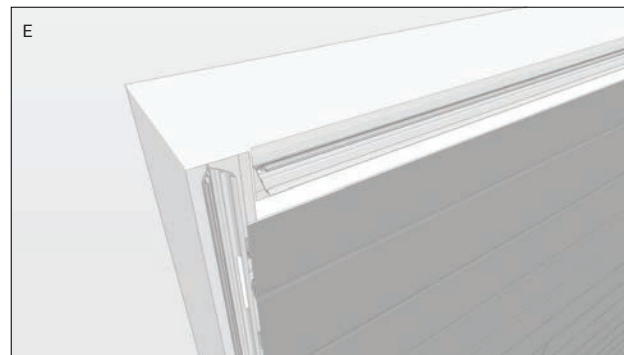
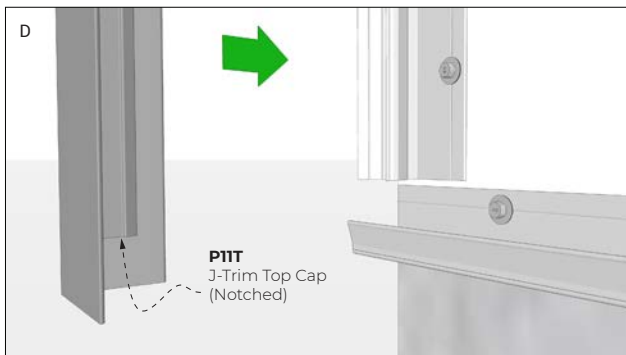
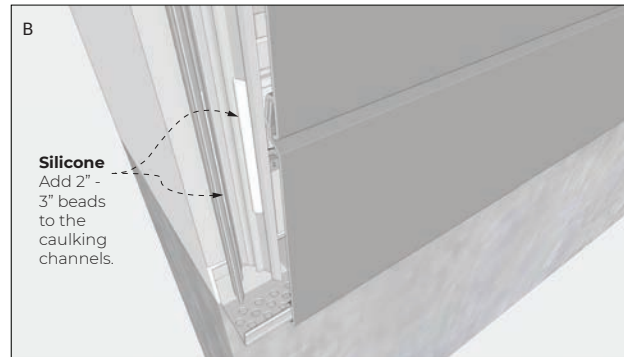
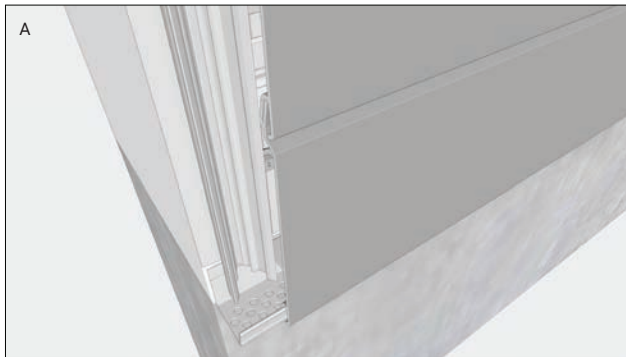

Install Top Caps (Page 2 of 2)

- Complete the Top Cap installation of the horizontal trims.
Add a 2" to 3" bead of Silicone to the caulking channels, every 2' to 3'.
- Notch the horizontal P11 J-Trim Top Cap to accommodate both vertical P11 J-Trim Top Caps.
- Secure the Top Cap to the Backplate Trim.

Silicone
Add 2" - 3" beads to
the caulking channels.

P11B
J-Trim Backplate

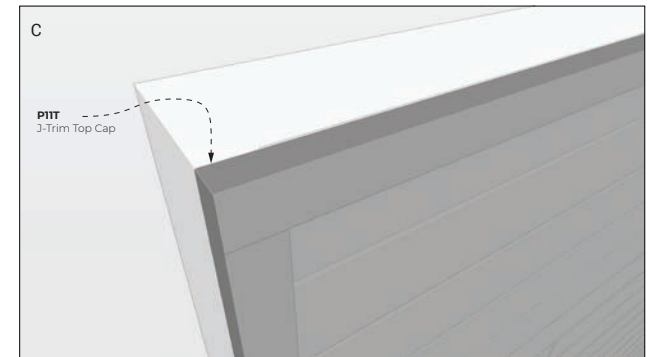
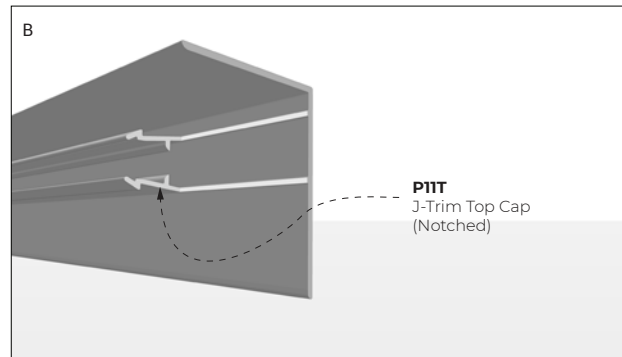
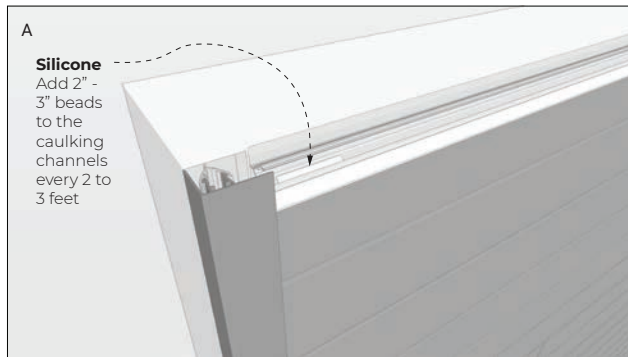
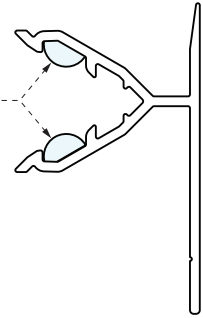



Note: A P23 FASTPLANK™ Connector (pictured in yellow) is necessary to fasten planks together butted end-to-end. A P23 FASTPLANK™ Connector is not necessary otherwise.

